

SSPI Interlock

Dome head · Steel body · Steel stem · Multi-grip
4.8 mm (3/16") - 10.0 mm (3/8")

Features

- Multi-grip structural breakstem fastener
- Excellent hole fill via radially expanded body provides greater joint integrity, added water resistance and compensates for irregular, oversized, slotted or misaligned holes
- Can stop sheet movement in non-standard holes
- Good sheet take-up performance for large gap closing capability
- Stem mechanically locked into body avoids damage, electrical problems or rattling caused by loose stems
- High shear and tensile strength

Material

- Body: Steel, zinc plated
- Stem: Steel, zinc plated, clear trivalent chromated

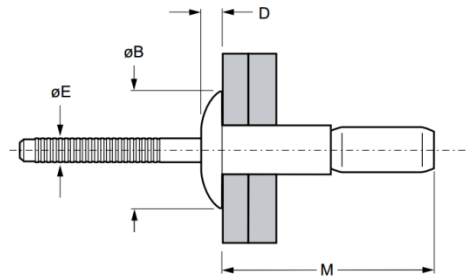

Before Placement

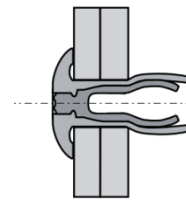

After Placement

Part No.	Size ø	Grip Range		Hole Size		M max.	øB max.	D max.	øE max.	Shear (typical) kN	Tension (typical) kN
		min.	max.	min.	max.						
SSPI-06-04	4.8 (3/16")	1.57	6.86	4.93	5.18	18.19	10.16	2.29	3.10	8.23	4.67
SSPI-06-07		5.44	11.10			25.48					
SSPI-E06-07		1.57	11.10			25.48					
SSPI-06-10		9.53	15.88			27.69					
SSPI-08-06	6.4 (1/4")	2.03	9.53	6.63	7.01	30.00	13.46	2.97	4.11	13.34	8.90
SSPI-08-10		8.89	15.88			33.66					
SSPI-E08-10		2.03	15.88			36.20					
SSPI-12-10	10.0 (3/8")	3.05	15.88	9.96	10.39	39.37	19.56	4.37	6.12	27.58	18.24



Can't find what you are looking for?

We can provide customized finishing and colouring.
Contact your nearest [Gripwell](#) team for assistance!